

1. DESIGNER AND WATER SERVING COORDINATOR:
QALCHEK PTY LTD (CERTIFIED No.289)
77 UNION RD. PENRITH NSW 2750
PH. No. (02) 4722 8181
- FOR: LEGPRO PTY LTD ATF LEGPRO 54 PTY LTD
LEVEL 27 - 19-29 MARTIN PLACE SYDNEY N.S.W 2000
PH: 92521111
2. THE WORKS AND MATERIALS ARE IN ACCORDANCE WITH THE SEWERAGE CODE OF AUSTRALIA WSA 02-2002-2.2 SYDNEY WATER EDITION VERSION 4 (2017) INCLUDING THE SYDNEY WATER SUPPLEMENT & APPENDICES.
3. ALL STRUCTURES WERE CONSTRUCTED TO FINISHED SURFACE LEVELS.
ALL LEVELS REFER TO FINISHED SURFACE LEVEL.
4. ALL BUILDING LAYOUTS, FINISHED SURFACE LEVELS, STORMWATER INFORMATION, AND GENERAL CIVIL ENGINEERING DETAILS TAKEN FROM J.WYNDHAM PRINCE ENGINEERING PLANS REFERENCE ISSUED FOR REVIEW PLANS 110358/CC504 REVISION 'B' DATED OCTOBER 2017
5. THE NUMBER OF FIELD COMPACTION TESTS CONDUCTED TO SATISFY THE SEWERAGE CODE OF AUSTRALIA WERE:

SAND/CEMENT BACKFILL WAS USED AT ROAD CROSSINGS. (LETTER PROVIDED)

PIPE EMBEDMENT ZONE: 0 TESTS CONDUCTED (LETTER PROVIDED)



TRENCH FILL ZONE (TRAFFICABLE): 0 TESTS CONDUCTED (LETTER PROVIDED)

TRENCH FILL ZONE (NON TRAFFICABLE): 54 TESTS CONDUCTED

TRENCH FILL ZONE (MAINTENANCE STRUCTURES): 116 TESTS CONDUCTED

TRENCH FILL ZONE - TOTAL: 170 TESTS CONDUCTED
6. BUILDING OVER/ADJACENT TO SEWER - CONDITIONS MAY APPLY. REFER TO QALCHEK FOR DETAILS.
7. ALL EXCAVATION, SHORING EXCAVATION AND STABILITY OF ADJACENT STRUCTURES/SERVICES/DWELLINGS WAS THE RESPONSIBILITY OF THE CONSTRUCTOR.
8. ALL PCS CONNECTIONS TO I.S. ARE AT 0.7m & 45° TO MAIN UNLESS OTHERWISE INDICATED.
↘ DENOTES STANDARD PCS CONNECTION (REFER DTC-2120 ISSUE A DATE 18.03.15)
9. THE WORKS WERE CONSTRUCTED IN ACCORDANCE WITH SYDNEY WATER'S DEEMED TO COMPLY DRAWINGS:

- FOR ALL MH'S DTC-2000 (ISSUE C 18-03-15), DTC-2220 (ISSUE D 18-03-15), DTC-2221 (ISSUE B 01.03.13), DTC-2222 (ISSUE C 18-03-15),
DTC-2203 (ISSUE B 18-03-15)
10. PIPES CONCRETE ENCASED SHOWN ACCORDINGLY:-  REFER TO SEW-1205-V
11. W.A.C. PREPARED FROM INFORMATION SUPPLIED (IN PART BY QALCHEK) & BY VINCE MORGAN SURVEYORS PTY LTD

 DENOTES ELECTRICAL SUBSTATION
 DENOTES DRIVEWAY
 DENOTES SERVICED BY CASE 162196WW

LOCALITY SKETCH AND ORIGIN OF LEVELS

O	WORK AS CONSTRUCTED	M.W.	16.10.18
B	LINE 8 & 10 AMENDED DUE TO BASIN UPGRADE	M.P	15.02.18
A	ISSUED FOR REVIEW	M.P	22.11.17
No.	AMENDMENT DESCRIPTION	BY	DATE

PLAN TO BE READ IN CONJUNCTION WITH CURRENT SYDNEY WATER STANDARDS SYDNEY WATER CORPORATION	UTILITIES						WORK AS CONSTRUCTED CERTIFICATION						PIPE SCHEDULE						NO AMENDMENTS ARE TO BE MADE TO THIS PLAN WITHOUT REFERENCE TO SYDNEY WATER. THIS PLAN IS NOT NECESSARILY UP TO DATE OR CORRECT AND SYDNEY WATER ACCEPTS NO RESPONSIBILITY.	<div>Sydney WATER</div> <div>SYDNEY WATER CORPORATION</div>						
	TYPE WATER: DN100 Water	DATE Feb'17	REF. Qalcheh	TYPE P.M 20623	DATE Sept'17	REF. SCIMS	DEVELOPER LEGPRO PTY LTD						SIZE 150	TYPE U.P.V.C	GLASS SN8	LENGTH 1546.64	PIPE JOINING METHOD / NOTES RJJ	AUSTRALIAN HEIGHT DATUM								
PRIOR TO COMMENCEMENT OF EXCAVATION FOR PROPOSED AND EXISTING SERVICES CONTACT :-	STORMWATER: SWD --- SWD						WATER SERVICE CO-ORDINATOR QALCHEK PTY LTD						CONSTRUCTOR FLUID SERVICES						COMPLETED 02.10.2018	W.A.C. PREPARED 16.10.2018					SCALES	
DIAL BEFORE YOU DIG Ph. 1100																			PLAN : 1:500	HOR. : 1:500		U.B. DIRECTORY 184 K4 (42nd Ed.)	Case No. 163996WW			
ELECTRICITY Ph.																			SECTION {	VERT. : 1:125				PENRITH SEWERAGE	DRAINS TO ST MARYS S.T.0011	
GAS Ph.																						SHEET . 1 . OF . 7 .	File No. N/A			
TELECOMMUNICATIONS Ph.							DESIGNER QALCHEK PTY LTD																	CROSS SECTIONS NATURAL		
SYDNEY WATER Ph. 132 092							I CERTIFY THAT THE WORKS HAVE BEEN CONSTRUCTED IN ACCORDANCE WITH THE WORK AS CONSTRUCTED DRAWINGS.						DESIGN HEAD . . . m	NO BOUNDARY TRAPS REQUIRED.		LENGTHS, DEPTHS & LEVELS ARE IN METRES.										
GIVING AT LEAST 48 HOURS NOTICE.																										

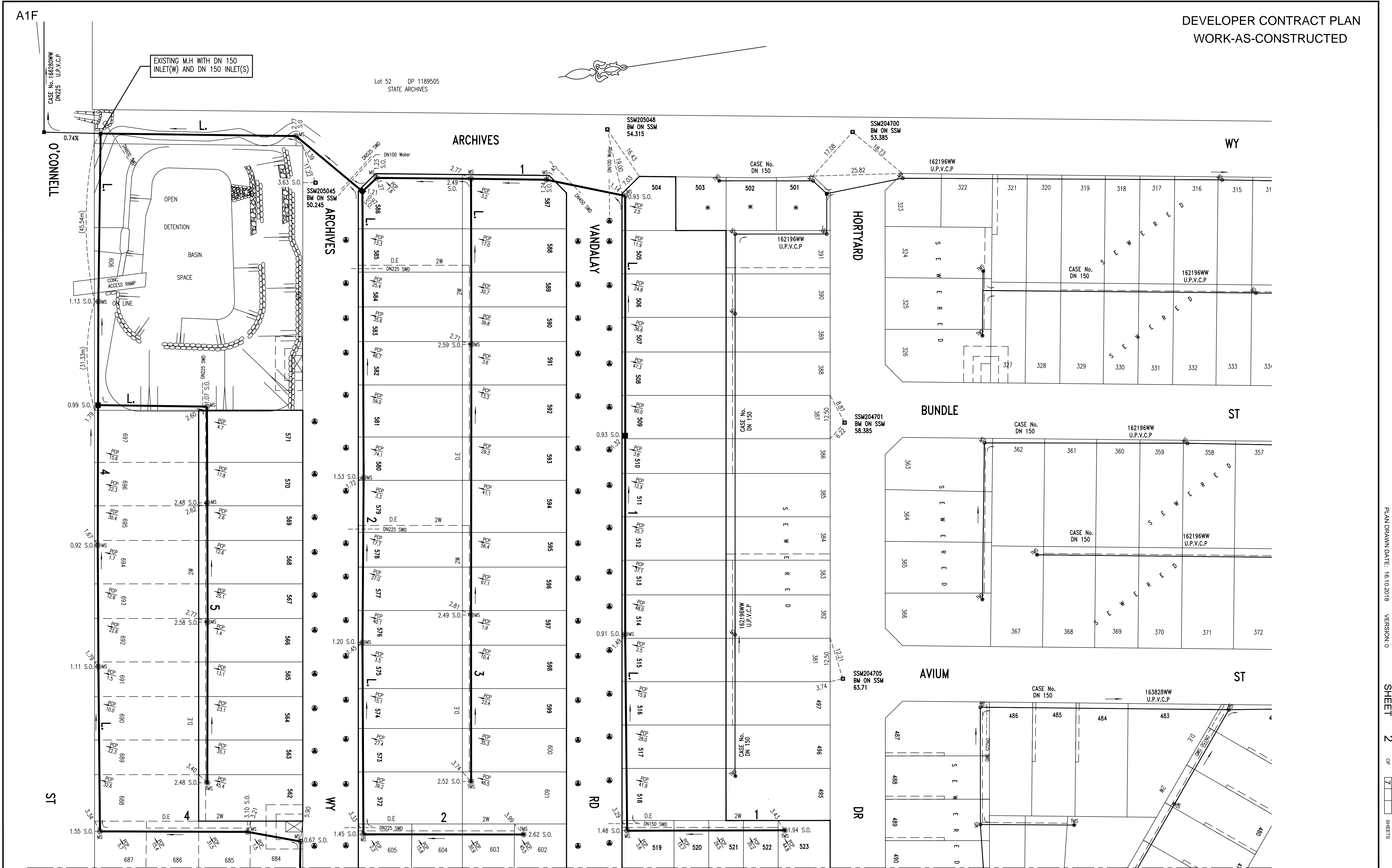

O	WORK AS CONSTRUCTED	M.W.	16.10.18
B	LINE 8 & 10 AMENDED DUE TO BASIN UPGRADE	M.P.	15.02.18
A	ISSUED FOR REVIEW	M.P.	22.11.17
No.	AMENDMENT DESCRIPTION	BY	DATE

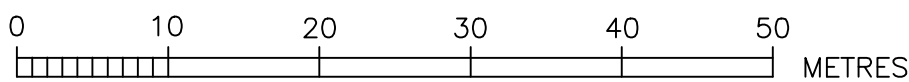

WORK AS CONSTRUCTED CERTIFICATION		Sydney WATER	
DEVELOPER	LEGPRO PTY LTD	SYDNEY WATER CORPORATION	
W.S.C.	QALCHEK PTY LTD	Case No. 163996WW SHT 2 OF 7 SHTS.	
CONSTRUCTOR	FLUID SERVICES	FOR DETAILS OF SERVICES SEE SHEET 1	
COMPLETED	02.10.2018		
W.A.C. PREPARED	16.10.2018	SYDNEY WATER CORPORATION	
DESIGNER	QALCHEK PTY LTD	FOR DETAILS OF SERVICES SEE SHEET 1	
I CERTIFY THAT THE WORKS HAVE BEEN CONSTRUCTED IN ACCORDANCE WITH THE WORK AS CONSTRUCTED DRAWINGS			

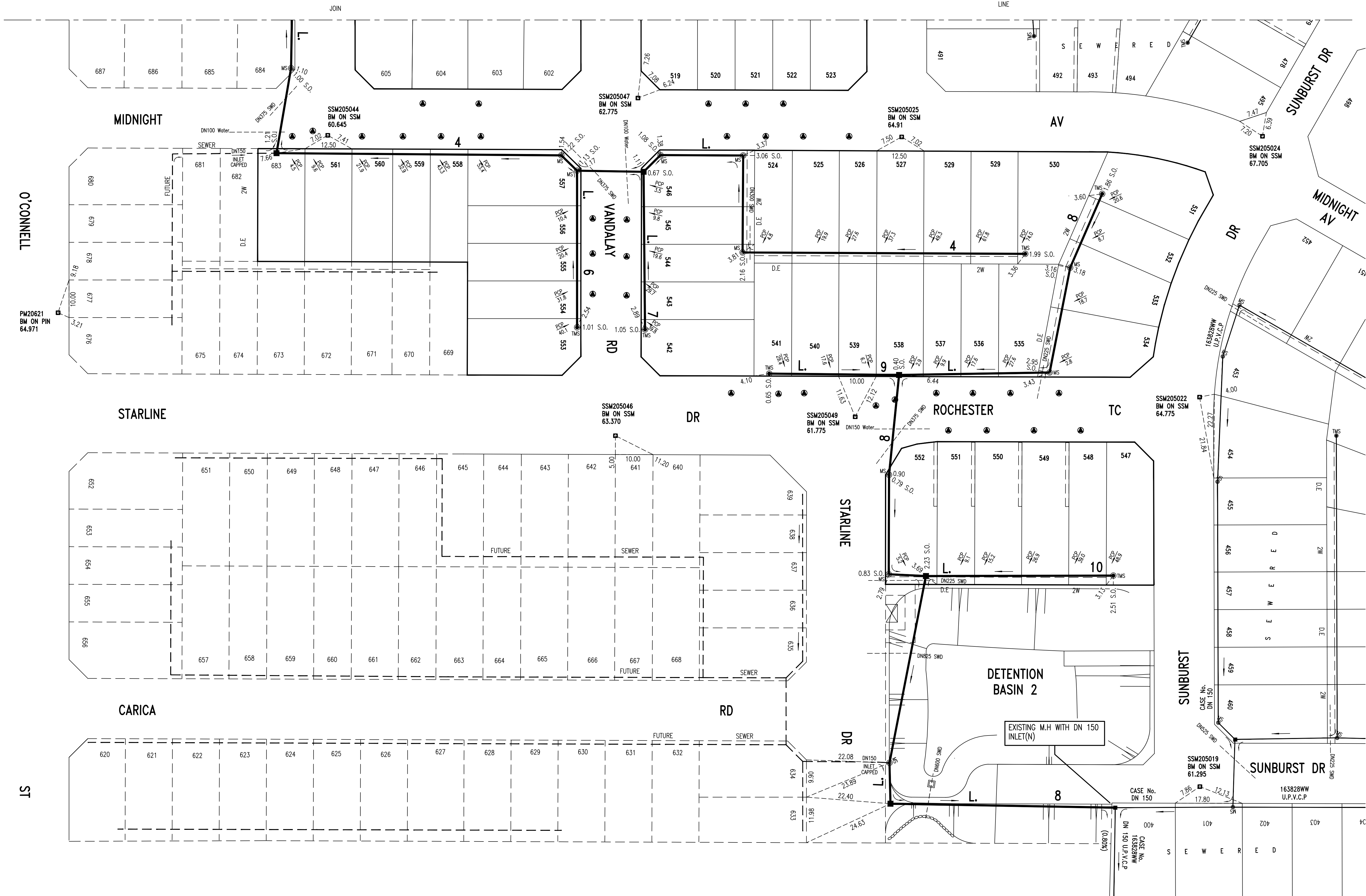

O	WORK AS CONSTRUCTED	M.W.	16.10.18
B	LINE 8 & 10 AMENDED DUE TO BASIN UPGRADE	M.P	15.02.18
A	ISSUED FOR REVIEW	M.P	22.11.17
No.	AMENDMENT DESCRIPTION	BY	DATE

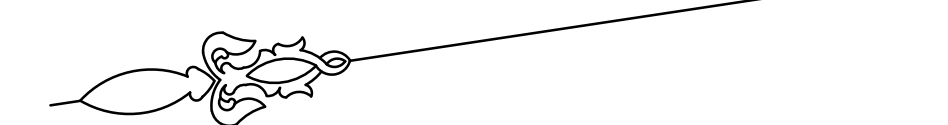
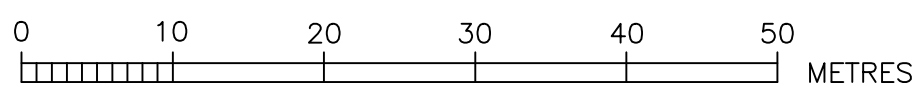

WORK AS CONSTRUCTED CERTIFICATION				Sydney <i>WATER</i>		SYDNEY WATER CORPORATION	
DEVELOPER	LEGPRO PTY LTD.			Case No. 163996WW		SHT 3 OF 7 SHTS.	
W.S.C.	QALCHEK PTY LTD.						
CONSTRUCTOR	FLUID SERVICES						
COMPLETED	02.10.2018						
W.A.C. PREPARED	16.07.2018						
DESIGNER	QALCHEK PTY LTD.						
I CERTIFY THAT THE WORKS HAVE BEEN CONSTRUCTED IN ACCORDANCE WITH THE WORK AS CONSTRUCTED DRAWINGS				SYDNEY WATER CORPORATION			
				FOR DETAILS OF SERVICES SEE SHEET 1			



WORK AS CONSTRUCTED CERTIFICATION		<div>Sydney WATER</div> <div>SYDNEY WATER CORPORATION</div>	
DEVELOPER	LEGPRO PTY LTD	Case No. 163996WW	SHT 4 OF 7 SHTS.
W.S.C.	QALCHEK PTY LTD		
CONSTRUCTOR	FLUID SERVICES		
COMPLETED	02.10.2018		
W.A.C. PREPARED	16.10.2018	<div>SYDNEY WATER CORPORATION</div> <div>FOR DETAILS OF SERVICES SEE SHEET 1</div>	
DESIGNER	QALCHEK PTY LTD		
I CERTIFY THAT THE WORKS HAVE BEEN CONSTRUCTED IN ACCORDANCE WITH THE WORK AS CONSTRUCTED DRAWINGS			

ALL MANHOLES DTC-2203 UNLESS SHOWN OTHERWISE

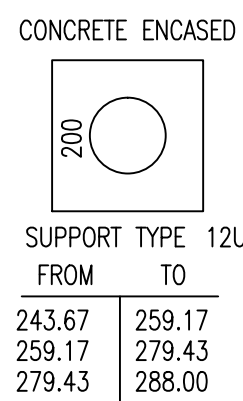

FILE LOCATION: PM19185WW-0

DESIGNED: M.P.

DRAFTED: M.W.

VERIFIED: C.T.

REVIEWED: C.T.

APPROVED: C.T.

ISSUED: 16.10.2018

LINE 4 CONTINUED BELOW

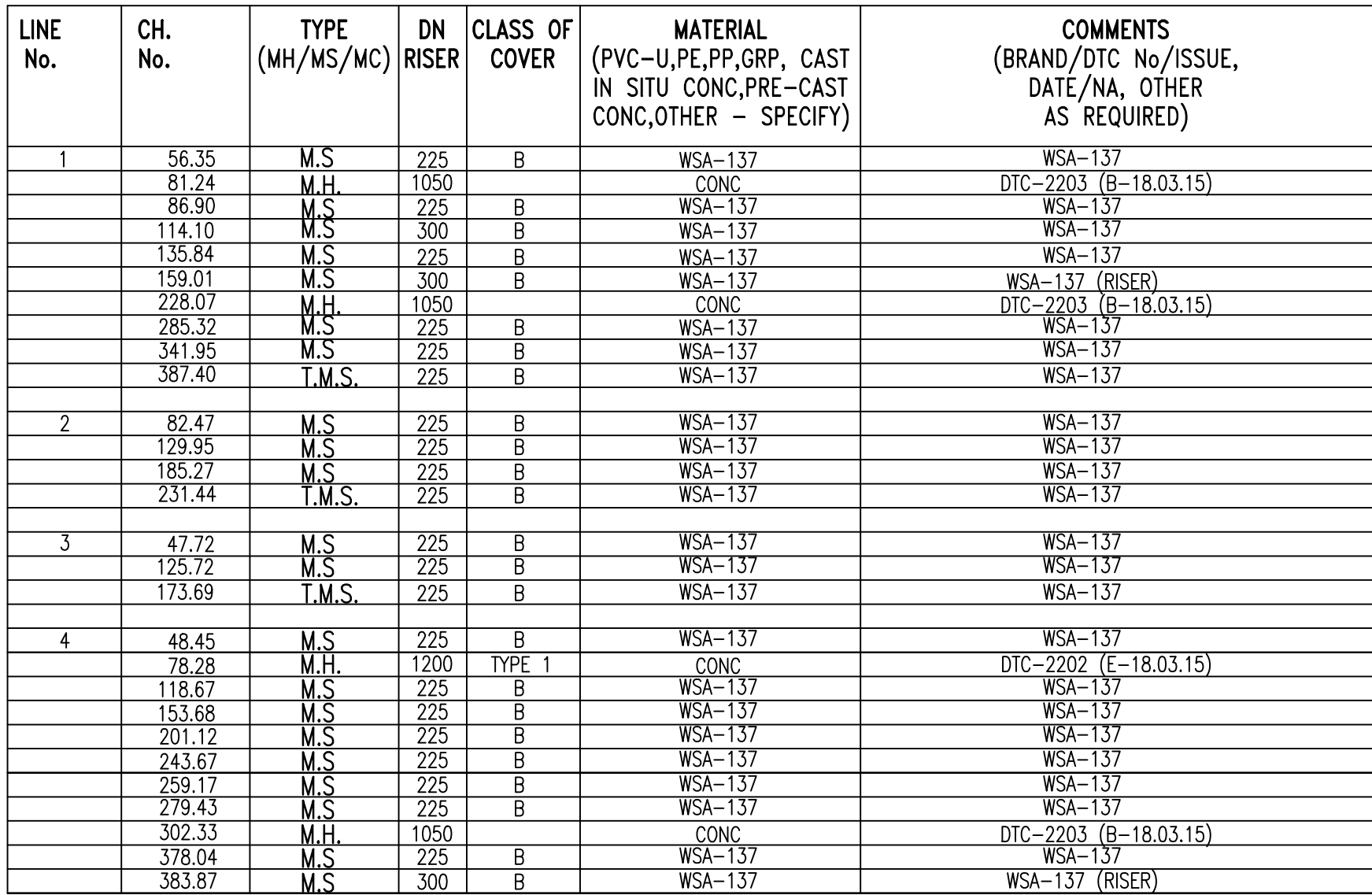

CONTINUED SHEET 6

WORK AS CONSTRUCTED CERTIFICATION		<div> <div> Sydney <i>WATER</i> </div> <div> SYDNEY WATER CORPORATION </div> </div>	
DEVELOPER	LEGPRO PTY LTD	<div> <div>Case No. 163996WWW</div> <div>SHT 5 OF 7 SHTS.</div> </div>	
W.S.C.	QALCHEK PTY LTD		
CONSTRUCTOR	FLUID SERVICES		
COMPLETED	02.10.2018		
W.A.C. PREPARED	16.10.2018		
DESIGNER	QALCHEK PTY LTD	SYDNEY WATER CORPORATION	
I CERTIFY THAT THE WORKS HAVE BEEN CONSTRUCTED IN ACCORDANCE WITH THE WORK AS CONSTRUCTED DRAWINGS		FOR DETAILS OF SERVICES SEE SHEET 1	

ALL MANHOLES DTC-2203 UNLESS SHOWN OTHERWISE

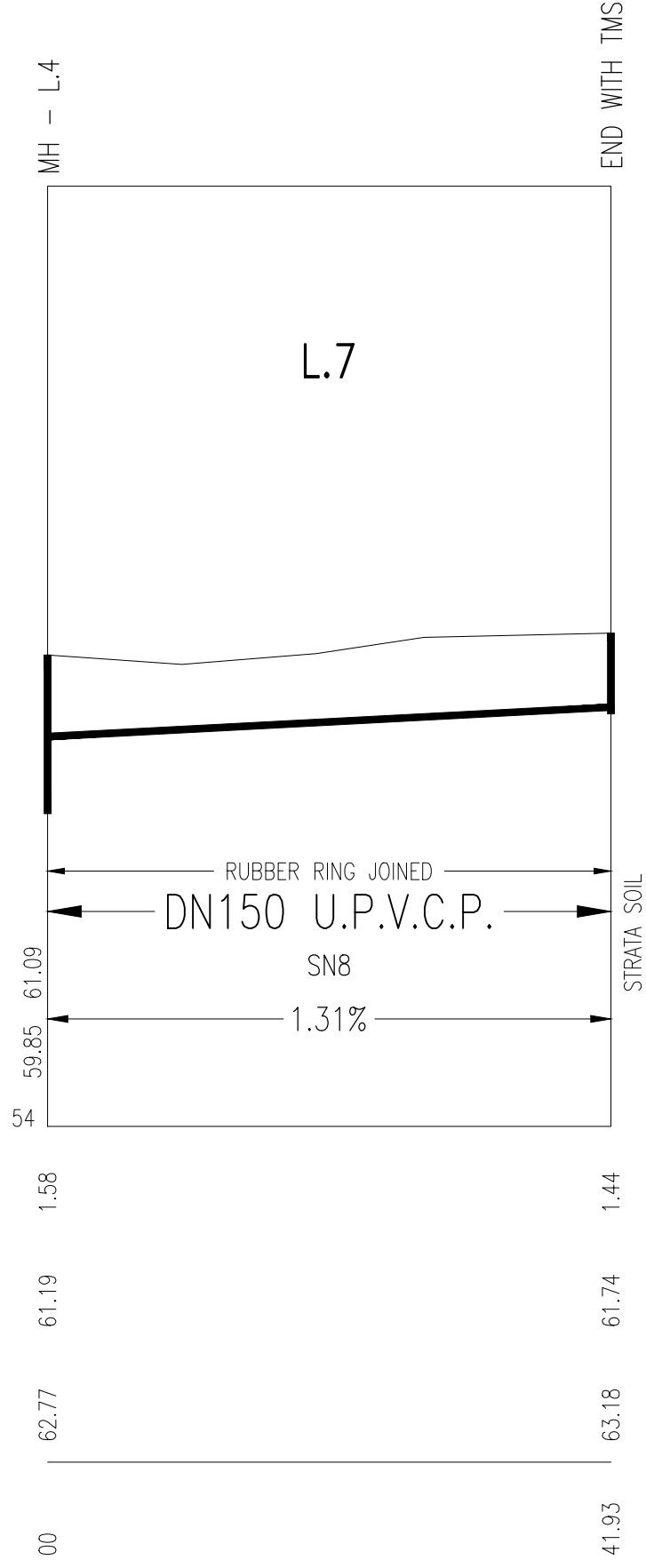
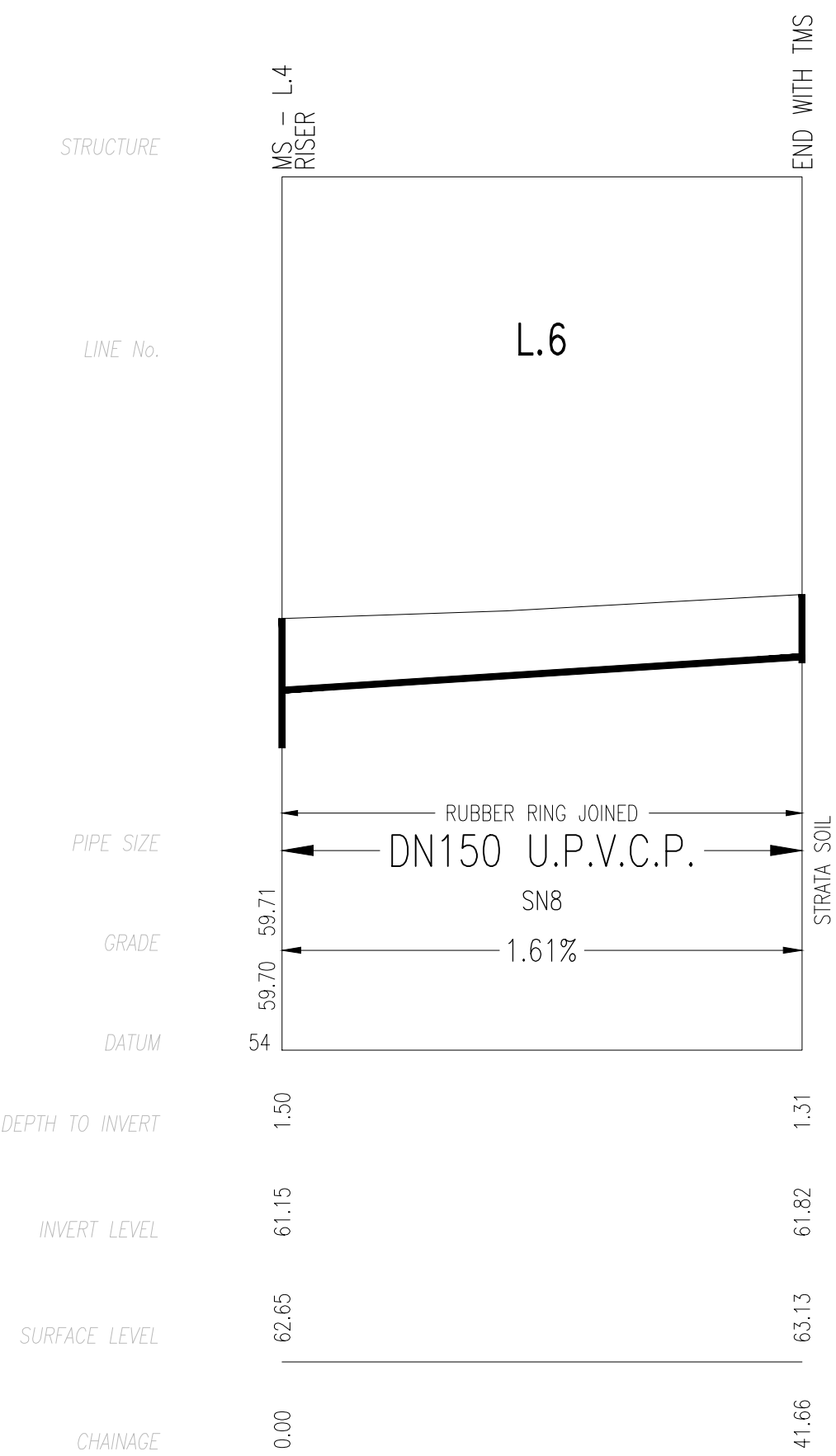
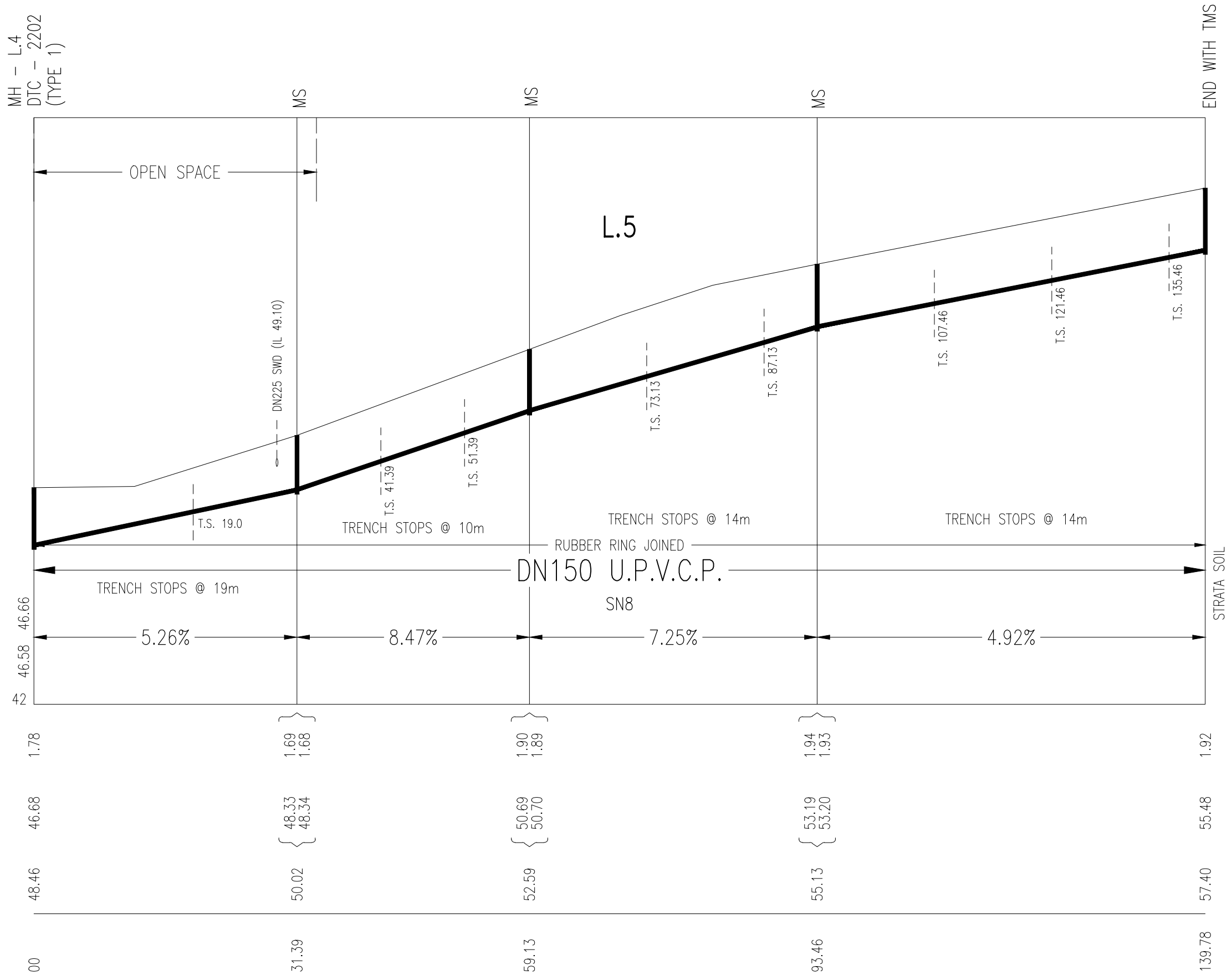
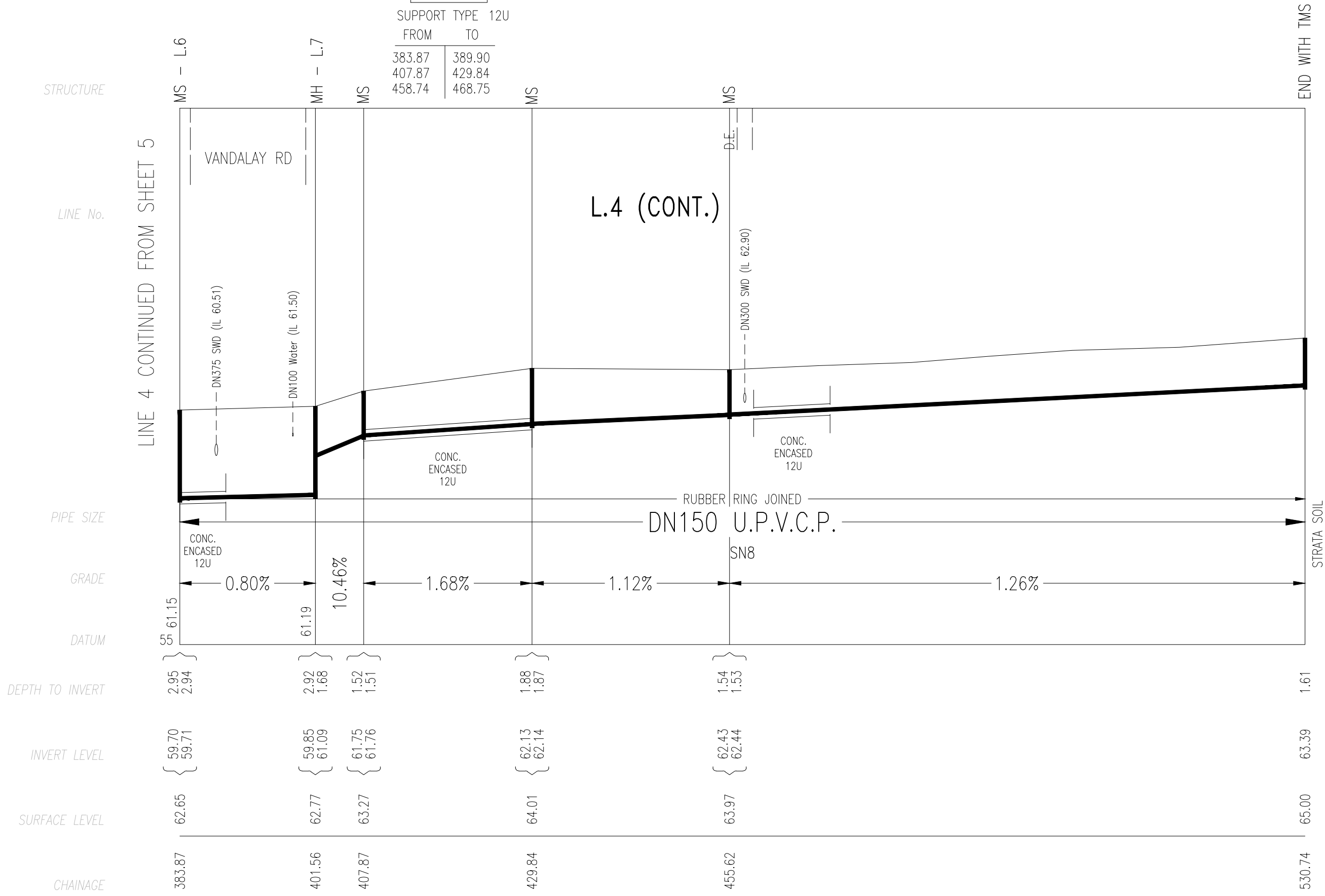

LINE No.	CH. No.	TYPE (MH/MS/MC)	DN	CLASS OF COVER	MATERIAL (PVC-U,PE,PP,GRP, CAST IN SITU CONC,PRE-CAST CONC,OTHER - SPECIFY)	COMMENTS (BRAND/DTC No/ISSUE, DATE/NA, OTHER AS REQUIRED)
4 (CONT'D)	401.56	M.H.	1050		CONC	DTC-2203 (B-18.03.15)
	407.87	M.S.	225	B	WSA-137	WSA-137
	429.84	M.S.	225	B	WSA-137	WSA-137
	455.62	M.S.	225	B	WSA-137	WSA-137
	530.74	T.M.S.	225	B	WSA-137	WSA-137
5	31.39	M.S.	225	B	WSA-137	WSA-137
	59.13	M.S.	225	B	WSA-137	WSA-137
	93.46	M.S.	225	B	WSA-137	WSA-137
	139.78	T.M.S.	225	B	WSA-137	WSA-137
6	41.66	T.M.S.	225	B	WSA-137	WSA-137
7	41.93	T.M.S.	225	B	WSA-137	WSA-137

O	WORK AS CONSTRUCTED	M.W.	16.10.18
B	LINE 8 & 10 AMENDED DUE TO BASIN UPGRADE	M.P.	15.02.18
A	ISSUED FOR REVIEW	M.P.	22.11.17
No.	AMENDMENT DESCRIPTION	BY	DATE

WORK AS CONSTRUCTED CERTIFICATION		SYDNEY WATER CORPORATION		
DEVELOPER	LEGPRO PTY LTD	Sydney WATER	Case No. 163996WW SHT 6 OF 7 SHTS.	
W.S.C.	QALCHEK PTY LTD			
CONSTRUCTOR	FLUID SERVICES	SYDNEY WATER CORPORATION		
COMPLETED	02.10.2018			
W.A.C. PREPARED	16.10.2018	FOR DETAILS OF SERVICES SEE SHEET 1		
DESIGNER	QALCHEK PTY LTD			
I CERTIFY THAT THE WORKS HAVE BEEN CONSTRUCTED IN ACCORDANCE WITH THE WORK AS CONSTRUCTED DRAWINGS				

ALL MANHOLES DTC-2203 UNLESS SHOWN OTHERWISE

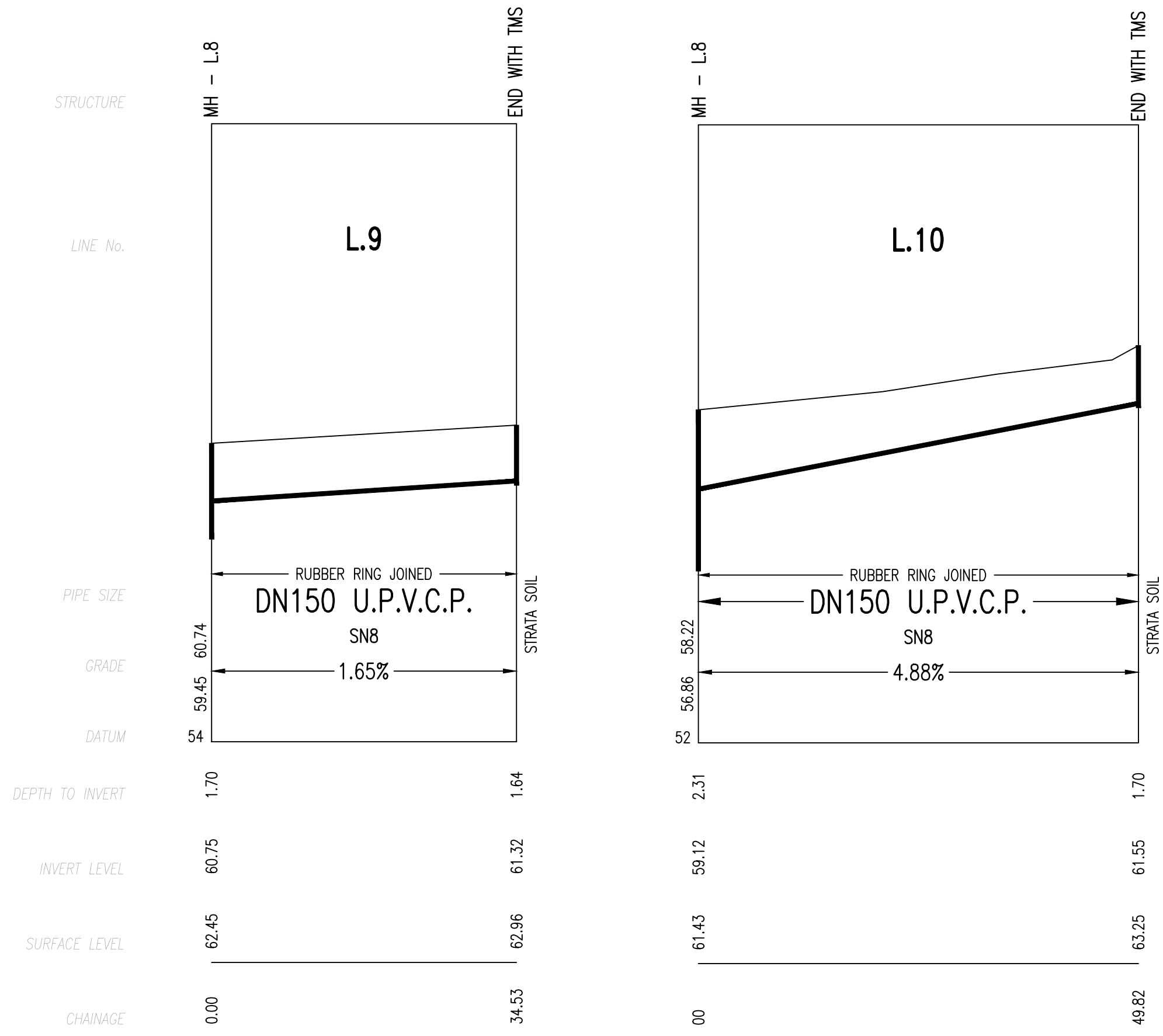
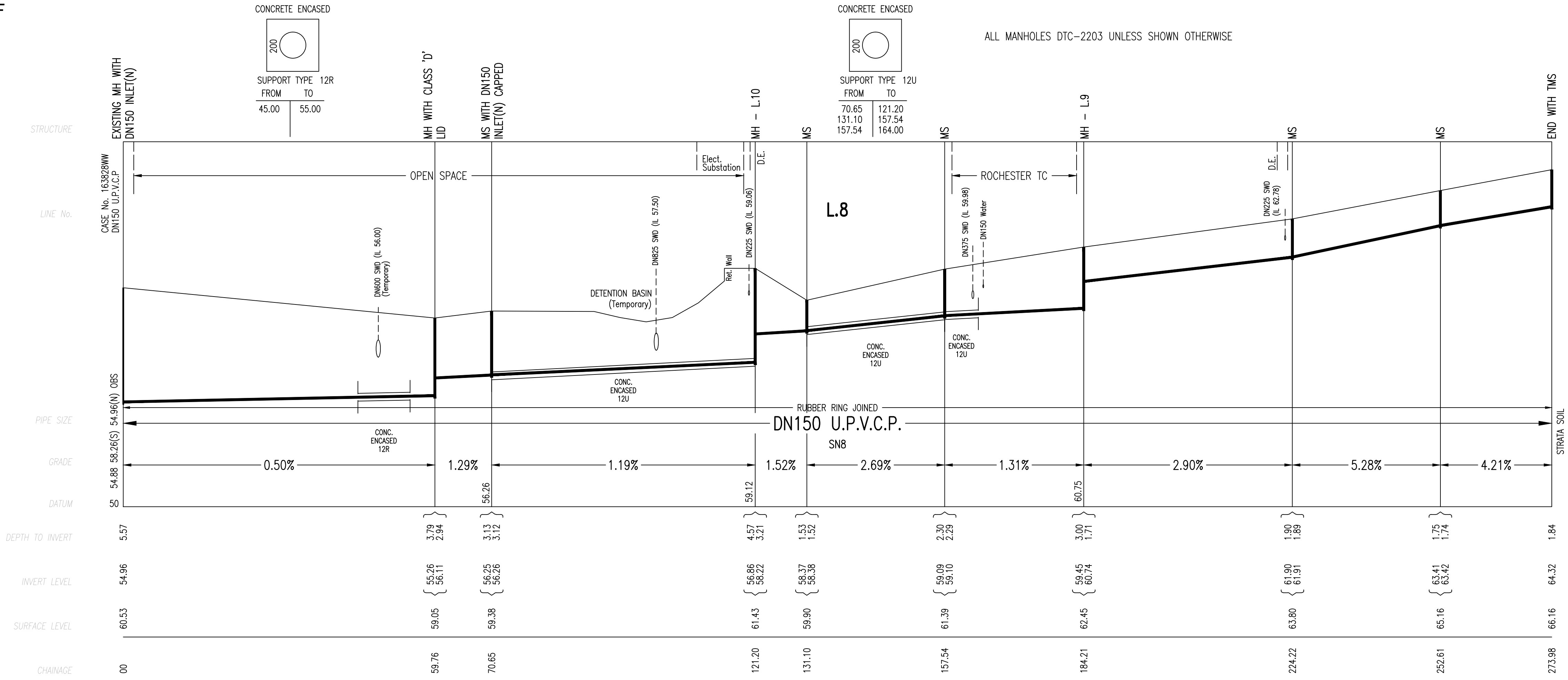

CONTINUED SHEET 6

LINE No.	CH. No.	TYPE (MH/MS/MC)	DN RISER	CLASS OF COVER	MATERIAL (PVC-U, PE, PP, GRP, CAST IN SITU CONC, PRE-CAST CONC, OTHER - SPECIFY)	COMMENTS (BRAND/DTC No/ISSUE, DATE/NA, OTHER AS REQUIRED)
8	59.76	M.H.	1050	D	CONC	DTC-2203 (B-18.03.15)
	70.65	M.S.	225	B	WSA-137	WSA-137
	121.20	M.H.	1050	B	CONC	DTC-2203 (B-18.03.15)
	131.10	M.S.	225	B	WSA-137	WSA-137
	157.54	M.S.	225	B	WSA-137	WSA-137
	184.21	M.H.	1050	B	CONC	DTC-2203 (B-18.03.15)
	224.22	M.S.	225	B	WSA-137	WSA-137
	252.61	M.S.	225	B	WSA-137	WSA-137
	273.98	T.M.S.	225	B	WSA-137	WSA-137
9	34.53	T.M.S.	225	B	WSA-137	WSA-137
10	49.82	T.M.S.	225	B	WSA-137	WSA-137

O	WORK AS CONSTRUCTED	M.W.	16.10.18
B	LINE 8 & 10 AMENDED DUE TO BASIN UPGRADE	M.P.	15.02.18
A	ISSUED FOR REVIEW	M.P.	22.11.17
No.	AMENDMENT DESCRIPTION	BY	DATE

WORK AS CONSTRUCTED CERTIFICATION		Sydney WATER SYDNEY WATER CORPORATION	
DEVELOPER	LEGPRO PTY LTD	Case No. 163996WW SHT 7 OF 7 SHTS.	
W.S.C.	QALCHEK PTY LTD		
CONSTRUCTOR	FLUID SERVICES	SYDNEY WATER CORPORATION FOR DETAILS OF SERVICES SEE SHEET 1	
COMPLETED	02.10.2018		
W.A.C. PREPARED	16.10.2018		
DESIGNER	QALCHEK PTY LTD		
I CERTIFY THAT THE WORKS HAVE BEEN CONSTRUCTED IN ACCORDANCE WITH THE WORK AS CONSTRUCTED DRAWINGS			