

1. DESIGNER AND WATER SERVICING COORDINATOR:
QALCHEK PTY LTD (CERTIFIED No.289)
77 UNION RD. PENRITH NSW 2750
PH. No. (02) 4722 8181
- FOR: LEGPRO PTY LTD ATF LEGPRO 54 PTY LTD
LEVEL 27 - 19-29 MARTIN PLACE SYDNEY N.S.W 2000
PH: 92521111
2. THE WORKS AND MATERIALS ARE IN ACCORDANCE WITH THE WATER
SUPPLY CODE OF AUSTRALIA (WSA 03-2011-3.1) INCLUDING THE SYDNEY
WATER SUPPLEMENT (2014) AND APPENDICES.
3. MAIN LAID GENERALLY 3m P.L. AT STANDARD DEPTH BELOW TOP OF KERB
EXCEPT WHERE OTHERWISE SHOWN.
4. ALL EXCAVATION, SHORING EXCAVATION AND STABILITY OF ADJACENT STRUCTURES
SERVICES/DWELLINGS WAS THE RESPONSIBILITY OF THE CONSTRUCTOR.
5. PRECAUTIONS MAY BE NECESSARY IN THE VICINITY OF SUB-STATION EARTHING.
6. ALL BUILDING LAYOUTS, FINISHED SURFACE LEVELS, STORMWATER INFORMATION, AND
GENERAL CIVIL ENGINEERING DETAILS TAKEN FROM J.WYNDHAM PRINCE ENGINEERING
PLANS REFERENCE ISSUED FOR REVIEW PLANS 110358 CC504 REVISION 'B' DATED OCTOBER 2017
7. THE NUMBER OF FIELD COMPACTION TESTS CONDUCTED TO SATISFY THE
WATER SUPPLY CODE OF AUSTRALIA ARE:
SAND/CEMENT BACKFILL IS USED AT RD CROSSINGS. (LETTER PROVIDED)
PIPE EMBEDMENT ZONE: 11 TESTS CONDUCTED
TRENCH FILL ZONE (TRAFFICABLE): 0 TESTS CONDUCTED (LETTER PROVIDED)
TRENCH FILL ZONE (NON TRAFFICABLE): 10 TESTS CONDUCTED
TRENCH FILL ZONE - TOTAL: 10 TESTS CONDUCTED
8. THE WORKS ARE CONSTRUCTED IN ACCORDANCE WITH SYDNEY
WATER'S DEEMED TO COMPLY DRAWINGS:
- FOR TEES DTC-1113 (ISSUE B 29.02.12)
- FOR VERTICAL BENDS & HYDRANT BENDS DTC-1114 (ISSUE A 31.01.12)
9. ALL SURFACE FITTINGS AND INDICATOR PLATES WERE RECOVERED.

- * DENOTES SERVICED BY CASE No. 163828PW
- DENOTES DRIVEWAY LOCATIONS
- ⊞ DENOTES ELECTRICAL SUBSTATION

LOCALITY SKETCH
(NOT TO SCALE)

O	WORK AS CONSTRUCTED	J.V.	21.11.18
D	DN150 MAIN EXTENDED STARLINE DR	MP	16.11.18
C	EXISTING WATER MAIN LABELS CHANGED	M.P	28.02.18
B	SYDNEY WATER ADDITIONAL VALVES LOT 560,641	M.P	05.02.18
A	ISSUED FOR REVIEW	M.P	19.08.17
No.	AMENDMENT DESCRIPTION	BY	DATE

PLAN TO BE READ IN CONJUNCTION WITH CURRENT SYDNEY WATER STANDARDS SYDNEY WATER CORPORATION	UTILITIES						WORK AS CONSTRUCTED CERTIFICATION						PIPE SCHEDULE					AUSTRALIAN HEIGHT DATUM	NO AMENDMENTS ARE TO BE MADE TO THIS PLAN WITHOUT REFERENCE TO SYDNEY WATER. THIS PLAN IS NOT NECESSARILY UP TO DATE OR CORRECT AND SYDNEY WATER ACCEPTS NO RESPONSIBILITY.	Sydney WATER SYDNEY WATER CORPORATION																																																																																																																																																																																																																																																																																																																																																																																																																																																																																																																																																																																																																																																																																																																																																																																																																																																																																																																																																																																																																																																																																																																																																																																																																																																																																																																																																																																																																																																																																																																																																																																																																																																																																																																						
	TYPE	DATE	REF.	TYPE	DATE	REF.	DEVELOPER	LEGPRO PTY LTD	WATER SERVICE CO-ORDINATOR	QALCHEK PTY LTD	CONSTRUCTOR	C.J. DOYLE	COMPLETED	13.08.2018	W.A.C. PREPARED	21.11.2018	DESIGNER			QALCHEK PTY LTD	I CERTIFY THAT THE WORKS HAVE BEEN CONSTRUCTED IN ACCORDANCE WITH THE WORK AS CONSTRUCTED DRAWINGS.	SIZE DN	TYPE	CLASS	LENGTH	PIPE JOINING METHOD / NOTES																																																																																																																																																																																																																																																																																																																																																																																																																																																																																																																																																																																																																																																																																																																																																																																																																																																																																																																																																																																																																																																																																																																																																																																																																																																																																																																																																																																																																																																																																																																																																																																																																																																																																																																
PRIOR TO COMMENCEMENT OF EXCAVATION FOR PROPOSED AND EXISTING SERVICES CONTACT :- DIAL BEFORE YOU DIG Ph.1100 ELECTRICITY Ph. GAS Ph. TELECOMMUNICATIONS Ph. SYDNEY WATER Ph.132 092 GIVING AT LEAST 48 HOURS NOTICE.	STORMWATER: SWD --- SWD	Aug'17	Jwp																																																																																																																																																																																																																																																																																																																																																																																																																																																																																																																																																																																																																																																																																																																																																																																																																																																																																																																																																																																																																																																																																																																																																																																																																																																																																																																																																																																																																																																																																																																																																																																																																																																																																																																																							

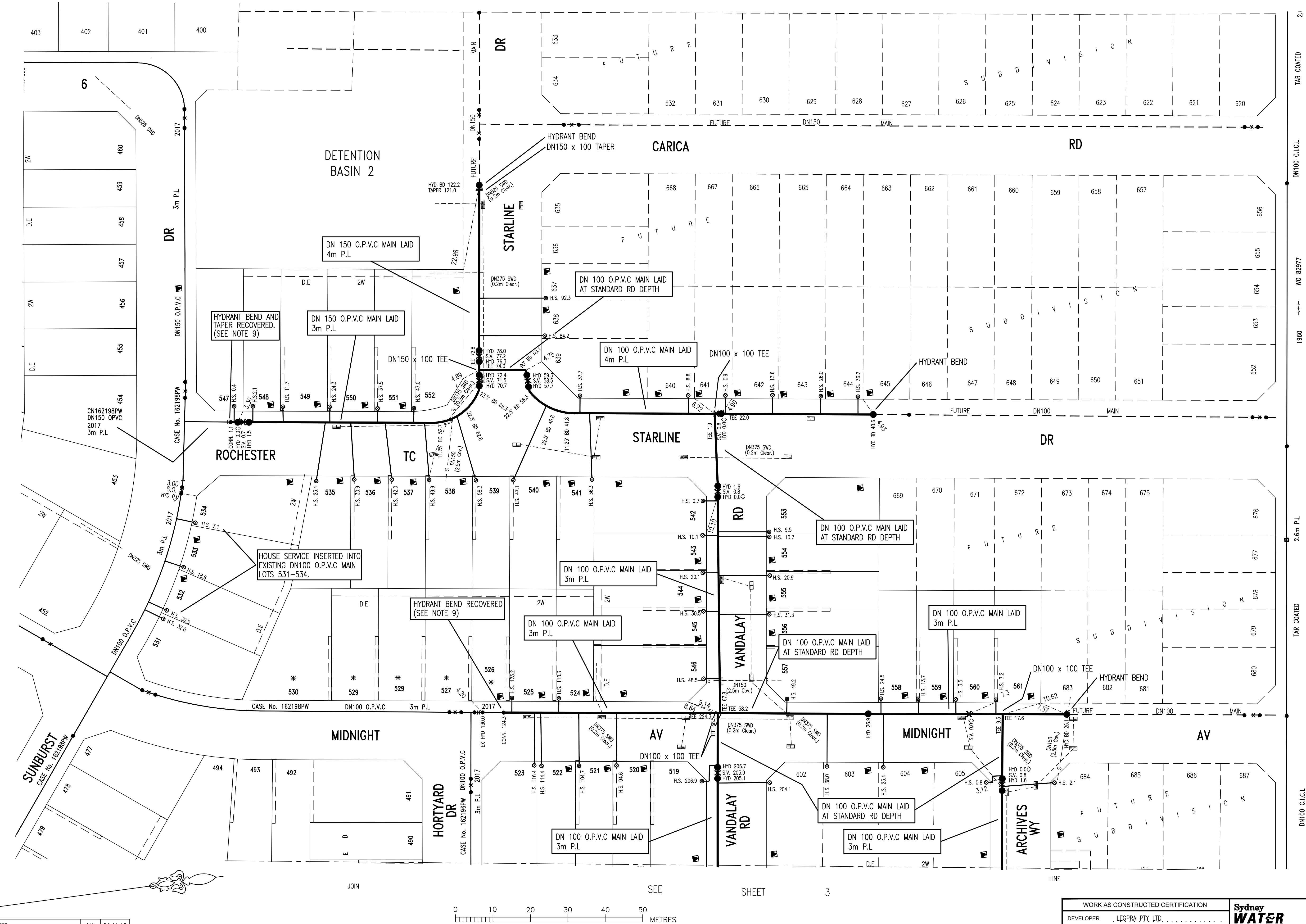

0	WORK AS CONSTRUCTED	J.V.	21.11.18
D	DN150 MAIN EXTENDED STARLINE DR	MP	16.11.18
C	EXISTING WATER MAIN LABELS CHANGED	M.P	28.02.18
B	SYDNEY WATER ADDITIONAL VALVES LOT 560,641	M.P	05.02.18
A	ISSUED FOR REVIEW	M.P	19.08.17
No.	AMENDMENT DESCRIPTION	BY	DATE

WORK AS CONSTRUCTED CERTIFICATION		Sydney Water	
DEVELOPER . LEGPRA PTY LTD		SYDNEY WATER CORPORATION	
W.S.C . QALCHEK PTY LTD		Case No. 163996PW	
CONSTRUCTOR C.J. DOYLE		SHT 2 OF 3 SHTS.	
COMPLETED . 13.08.2018			
W.A.C. PREPARED . 21.11.2018			
DESIGNER . QALCHEK PTY LTD		SYDNEY WATER CORPORATION	
I CERTIFY THAT THE WORKS HAVE BEEN CONSTRUCTED IN ACCORDANCE WITH THE WORK AS CONSTRUCTED DRAWINGS		FOR DETAILS OF SERVICES SEE SHEET 1	
FILE LOCATION: PM19185PW-0		DESIGNED: M.P	
DRAFTED: J.V.		VERIFIED: C.T	
REVIEWED: C.T		APPROVED: C.T	
ISSUED: 21.11.2018			

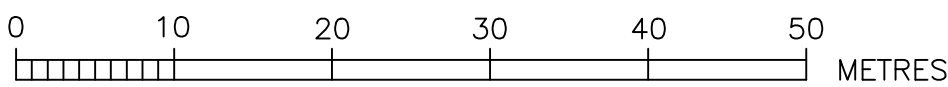

* DENOTES LOT SERVICED BY CASE 163828PW
 DENOTES DRIVEWAY LOCATIONS
 DENOTES ELECTRICAL SUBSTATION

WORK AS CONSTRUCTED CERTIFICATION		 SYDNEY WATER CORPORATION	
DEVELOPER	LEGPRO PTY LTD	Case No. 163996PW	SHT 3 OF 3 SHTS
W.S.C.	QALCHEK PTY LTD		
CONSTRUCTOR	C.J. DOYLE		
COMPLETED	13.08.2018		
W.A.C. PREPARED	21.11.2018	SYDNEY WATER CORPORATION FOR DETAILS OF SERVICES SEE SHEET 1	
DESIGNER	QALCHEK PTY LTD		
I CERTIFY THAT THE WORKS HAVE BEEN CONSTRUCTED IN ACCORDANCE WITH THE WORK AS CONSTRUCTED DRAWINGS			