

- 1. DESIGNER AND WATER SERVICING COORDINATOR:
QALCHEK PTY LTD (CERTIFIED No.289)
77 UNION RD. PENRITH NSW 2750
PH. No. (02) 4722 8181

FOR: LEGPRO PTY LTD ATF LEGPRO 54 PTY LTD
LEVEL 27 - 19-29 MARTIN PLACE SYDNEY N.S.W 2000
PH: 92521111
- 2. THE WORKS AND MATERIALS WERE IN ACCORDANCE WITH THE WATER SUPPLY CODE OF AUSTRALIA (NSA 03-2011-3.1) INCLUDING THE SYDNEY WATER SUPPLEMENT (2014) AND APPENDICES.
- 3. MAIN LAID GENERALLY 3m P.L. AT STANDARD DEPTH BELOW TOP OF KERB EXCEPT WHERE OTHERWISE SHOWN.
- 4. ALL EXCAVATION, SHORING EXCAVATION AND STABILITY OF ADJACENT STRUCTURES SERVICES/DWELLINGS WAS THE RESPONSIBILITY OF THE CONSTRUCTOR.
- 5. ALL BUILDING LAYOUTS, FINISHED SURFACE LEVELS, STORMWATER INFORMATION, AND GENERAL CIVIL ENGINEERING DETAILS TAKEN FROM J.WYNDHAM PRINCE ENGINEERING PLANS REFERENCE DRAFT PLANS 110358/CC204 REVISION 'A' DATED '18-05-2017'
- 6. THE MINIMUM NUMBER OF FIELD COMPACTION TESTS CONDUCTED TO SATISFY THE WATER SUPPLY CODE OF AUSTRALIA ARE:
SAND/CEMENT BACKFILL WAS USED AT ROAD CROSSINGS (LETTER PROVIDED)
PIPE EMBEDMENT ZONE: 13 TESTS CONDUCTED
TRENCH FILL ZONE (TRAFFICABLE): 0 TESTS CONDUCTED (LETTER PROVIDED)
TRENCH FILL ZONE (NON TRAFFICABLE): 13 TESTS CONDUCTED
TRENCH FILL ZONE - TOTAL: 13 TESTS CONDUCTED
- 7. CONSTRUCTOR ENSURED THAT WORKS WERE CONSTRUCTED IN ACCORDANCE WITH SYDNEY WATER'S DEEMED TO COMPLY DRAWINGS:
 - FOR TAPERS DTC-1112 (ISSUE B 29.02.12)
 - FOR TEES DTC-1113 (ISSUE B 29.02.12)
 - FOR VERTICAL BENDS & HYDRANT BENDS DTC-1114 (ISSUE A 31.01.12)

- * DENOTES LOT 432 SERVICED BY CASE 162195PW
- DENOTES DRIVEWAY LOCATIONS
- ⊞ DENOTES ELECTRICAL SUBSTATION

LOCALITY SKETCH
(NOT TO SCALE)

0	WORK AS CONSTRUCTED	G.M.	02.07.18
A	DRAFT	M.P	19.08.17
No.	AMENDMENT DESCRIPTION	BY	DATE

PLAN TO BE READ IN CONJUNCTION WITH CURRENT SYDNEY WATER STANDARDS SYDNEY WATER CORPORATION PRIOR TO COMMENCEMENT OF EXCAVATION FOR PROPOSED AND EXISTING SERVICES CONTACT :- DIAL BEFORE YOU DIG Ph.1100 ELECTRICITY, ENDEAVOUR ENERGY Ph.131 003 GAS PHENIX GAS Ph.1300 880 806 TELECOMMUNICATIONS TELSTRA Ph.1800 114 918 SYDNEY WATER Ph.132 092 GIVING AT LEAST 48 HOURS NOTICE.	UTILITIES					WORK AS CONSTRUCTED CERTIFICATION					PIPE SCHEDULE					AUSTRALIAN HEIGHT DATUM		NO AMENDMENTS ARE TO BE MADE TO THIS PLAN WITHOUT REFERENCE TO SYDNEY WATER. THIS PLAN IS NOT NECESSARILY UP TO DATE OR CORRECT AND SYDNEY WATER ACCEPTS NO RESPONSIBILITY.		<div>Sydney WATER</div> <div>SYDNEY WATER CORPORATION</div>	
	TYPE	DATE	REF.	TYPE	DATE	REF.	DEVELOPER	LEGPPO PTY LTD	SIZE DN	TYPE	CLASS	LENGTH	PIPE JOINING METHOD / NOTES								
	STORMWATER: SMD	Feb'17	Jwp				WATER SERVICE CO-ORDINATOR QALCHEK PTY LTD		100	OPVC	PN16	809.6	RRJ								
	SEWER: S	Feb'17	Qalchek				CONSTRUCTOR C.J. DOYLE PTY LTD		150	OPVC	PN16	484.1	RRJ								
							COMPLETED 15.05.2018	W.A.C. PREPARED 02.07.18													
							DESIGNER QALCHEK PTY LTD														
							I CERTIFY THAT THE WORKS HAVE BEEN CONSTRUCTED IN ACCORDANCE WITH THE WORK AS CONSTRUCTED DRAWINGS.							DESIGN HEAD 120 m	BOUNDARY TRAPS REQUIRED.						

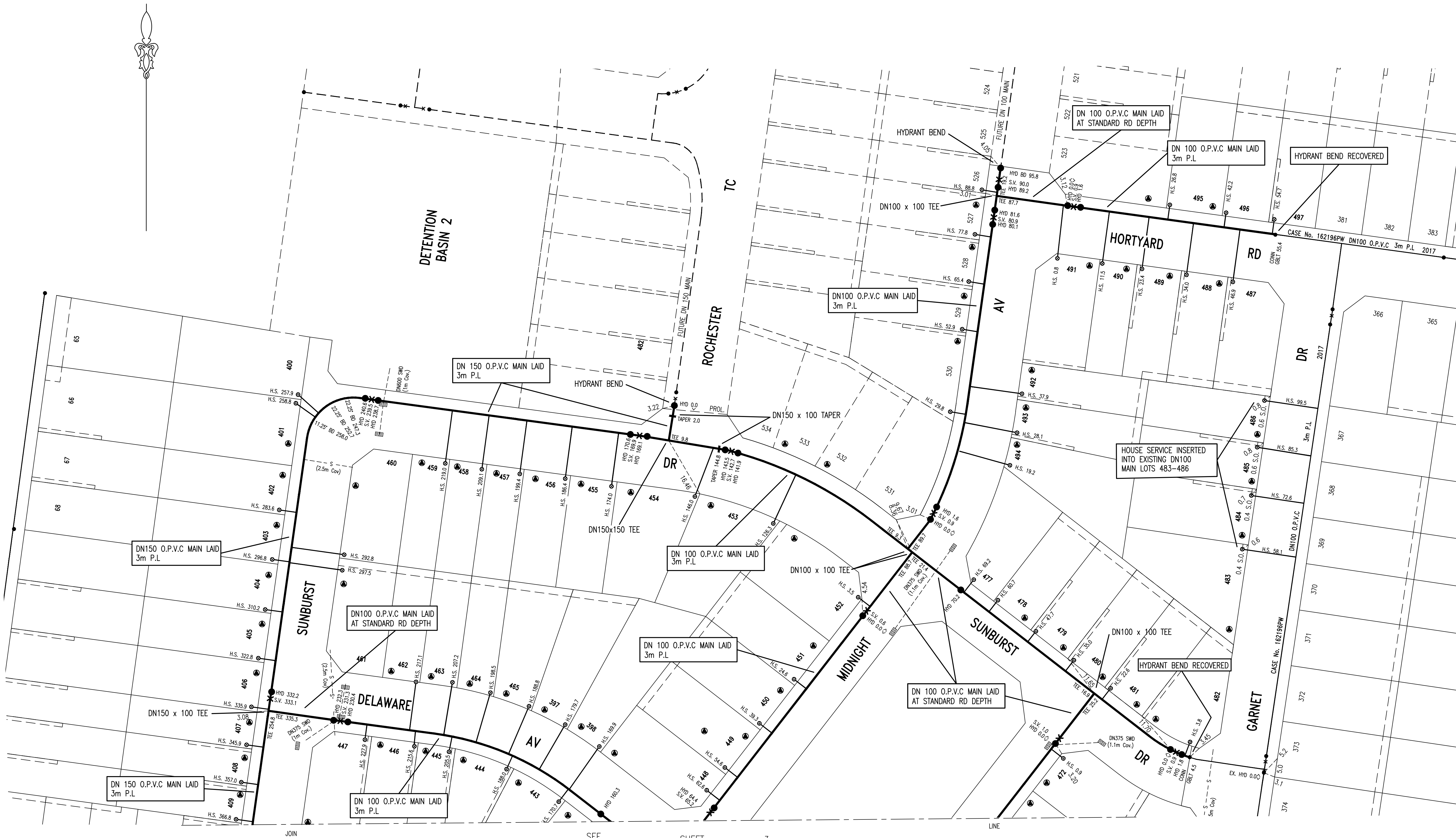

PLAN DRAWN DATE: 02.07.2018 VERSION: 0 SHEET 2 OF 3 SHEETS

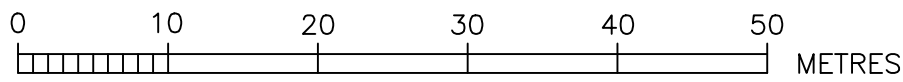

- * DENOTES LOT 432 SERVICED BY CASE 162195PW
- DENOTES DRIVEWAY LOCATIONS
- ⊠ DENOTES ELECTRICAL SUBSTATION

0	WORK AS CONSTRUCTED	G.M.	02.07.18
A	DRAFT	M.P	19.08.17
No.	AMENDMENT DESCRIPTION	BY	DATE

WORK AS CONSTRUCTED CERTIFICATION		SYDNEY WATER CORPORATION	
DEVELOPER	LEGPRO PTY LTD.	<div>Sydney <i>WATER</i></div>	
W.S.C.	QALCHEK PTY LTD.		
CONSTRUCTOR	CJ DOYLE PTY LTD.	Case No. 163828PW	SHT 2 OF 3 SHTS.
COMPLETED	15.05.2018		
W.A.C. PREPARED	02.07.18		
DESIGNER	QALCHEK PTY LTD.	SYDNEY WATER CORPORATION	
I CERTIFY THAT THE WORKS HAVE BEEN CONSTRUCTED IN ACCORDANCE WITH THE WORK AS CONSTRUCTED DRAWINGS		FOR DETAILS OF SERVICES SEE SHEET 1	

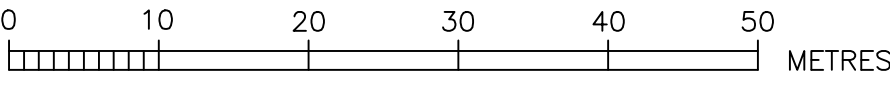
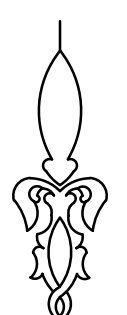
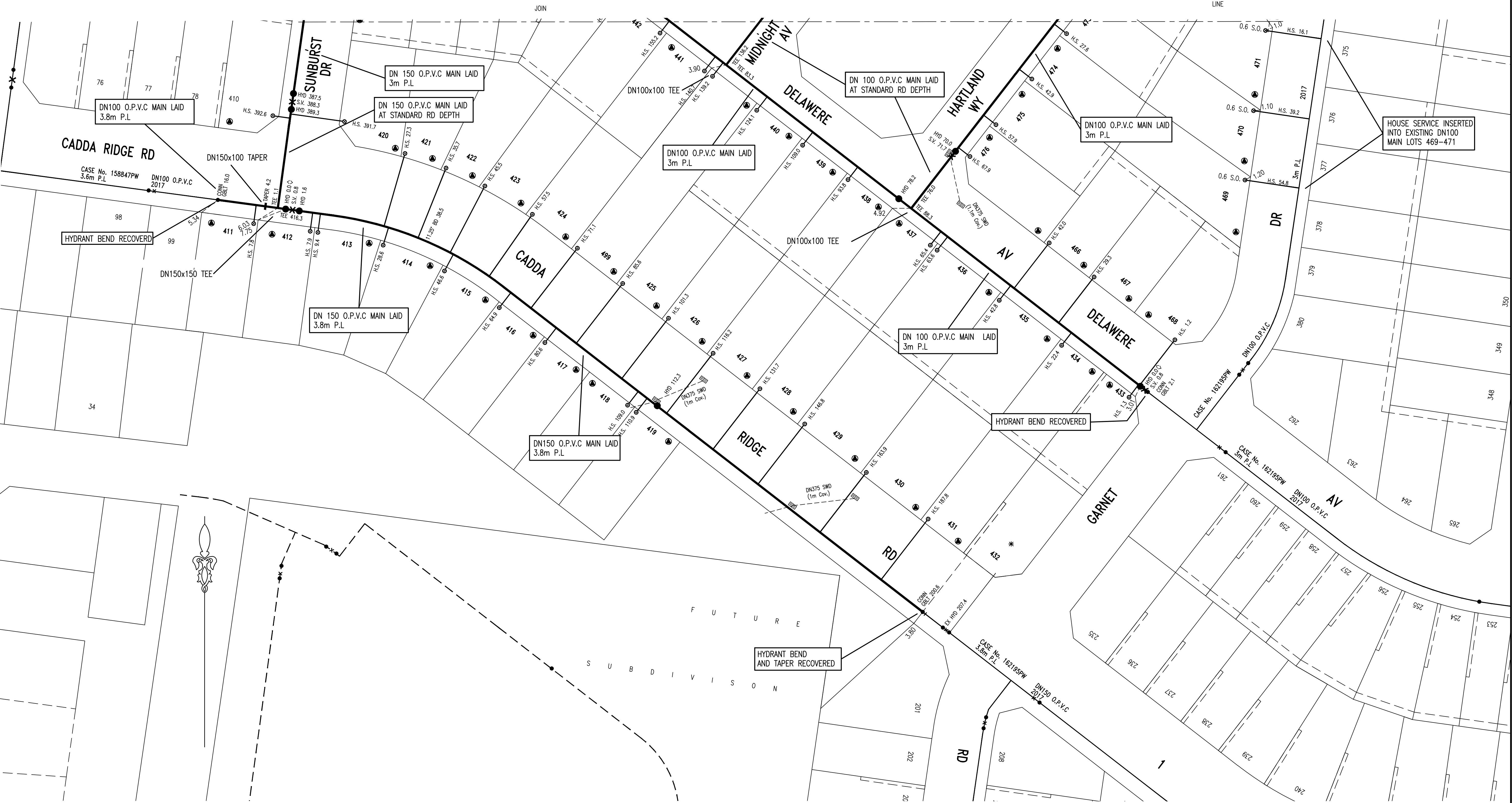

- * DENOTES LOT 432 SERVICED BY CASE 162195PW
- DENOTES DRIVEWAY LOCATIONS
- ⊗ DENOTES ELECTRICAL SUBSTATION

0	WORK AS CONSTRUCTED	G.M.	02.07.18
A	DRAFT	M.P	19.08.17
No.	AMENDMENT DESCRIPTION	BY	DATE

WORK AS CONSTRUCTED CERTIFICATION

DEVELOPER

W.S.C.

CONSTRUCTOR

COMPLETED

W.A.C. PREPARED

DESIGNER

LEGPRO PTY. LTD.

QALCHEK PTY LTD.

CJ DOYLE PTY LTD.

15.05.2018

02.07.18

QALCHEK PTY LTD.

Sydney WATER

CASE No. 163828PW

SH 3 OF 3 SHTS.

SYDNEY WATER CORPORATION

FOR DETAILS OF SERVICES SEE SHEET 1